



JET PUMPS

S1P-14S, Z, PZ
S1P-24S, Z, PZ
S1P-34S, Z, PZ
S1P-44S, Z, PZ

GENERAL CHARACTERISTICS

The jet pumps are devices used for oxygenation and mixing of wastewater in biological treatment processes, as well as in the processes of biological reconstruction of all kinds of sewage where aeration of the medium is required. The jet pumps produce a strong stream of mixture of sewage and air bubbles, creating particularly favorable conditions for oxygen transfer and preventing sedimentation of sediments.

The jet pumps S1 are intended for tanks with active depths $H_{cz} < 4,5m$

TECHNICAL DATA

Name		S1-14	S1-24	S1-34	S1-44
Pump type		MSV-80-14	MSV-80-24	MSV-80-34	MSV-80-44
Pump power [kW]		1,5	2,2	3,0	4,0
Immersion depth [m]	min	0,8	0,8	0,8	0,8
	max	4,0	4,0	4,0	4,5
Mixing rate [m ³ /h]		33	39	61	72
Oxygen transfer max [kgO ₂ /h]		2,05	3,12	4,29	5,75
Oxygenation efficiency max [kgO ₂ /kWh]		1,36	1,42	1,43	1,44
Device weight [kg]	S	76	79	108	118
	PZ	82	85	114	124
	Z	78	81	110	120

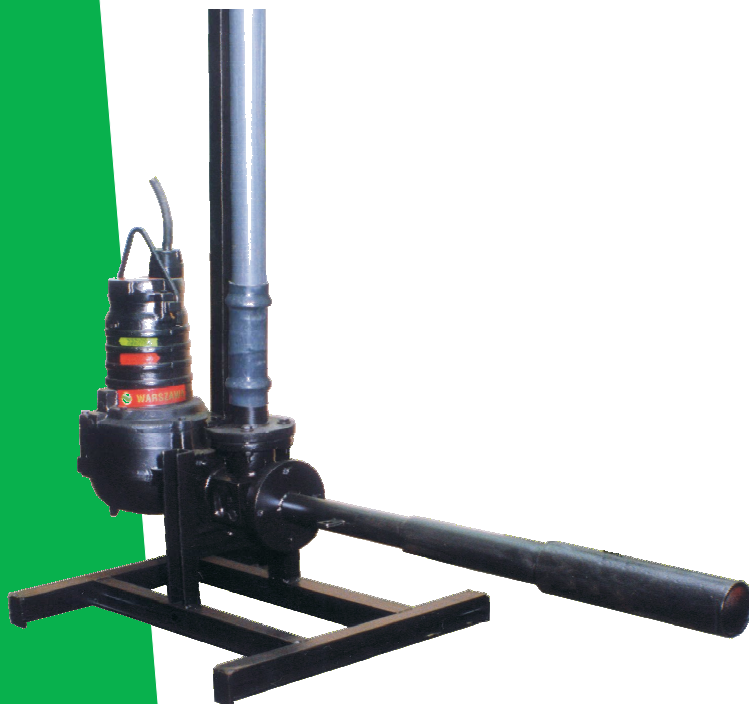

APPLIED MATERIALS

- Pump, - cast iron HT200, HT250.
- Suction chamber, supporting structures - stainless steel.
- Ejector elements - stainless steel.
- Suction pipe - PVC.
- Cast iron with paint finish epoxy.

AERATION OUTPUT

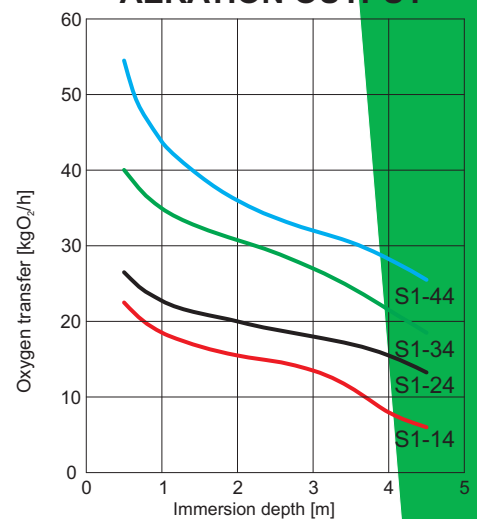

OXYGEN TRANSFER

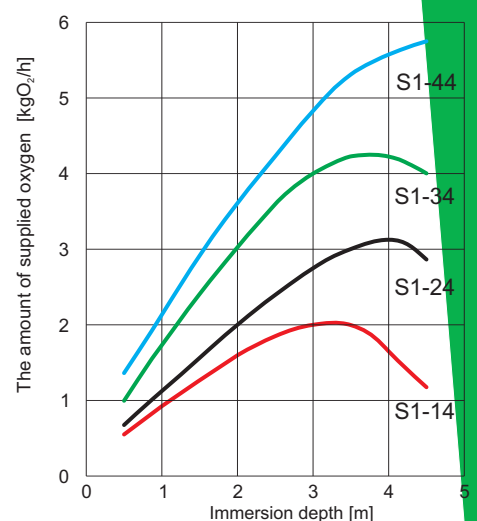

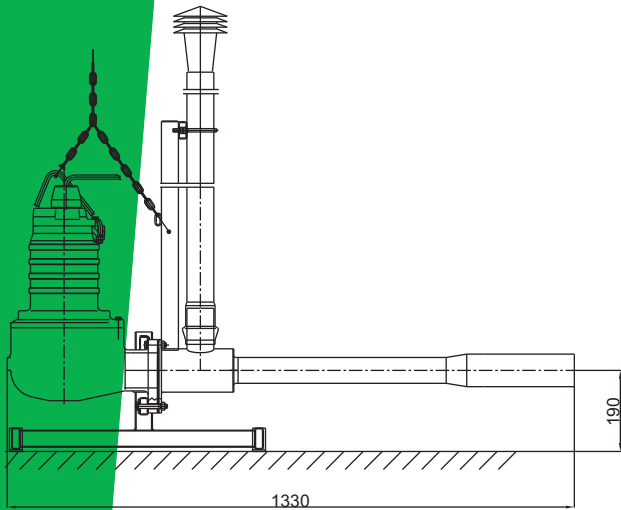

Jet pump S1-14S; -24S; -34S; -44S

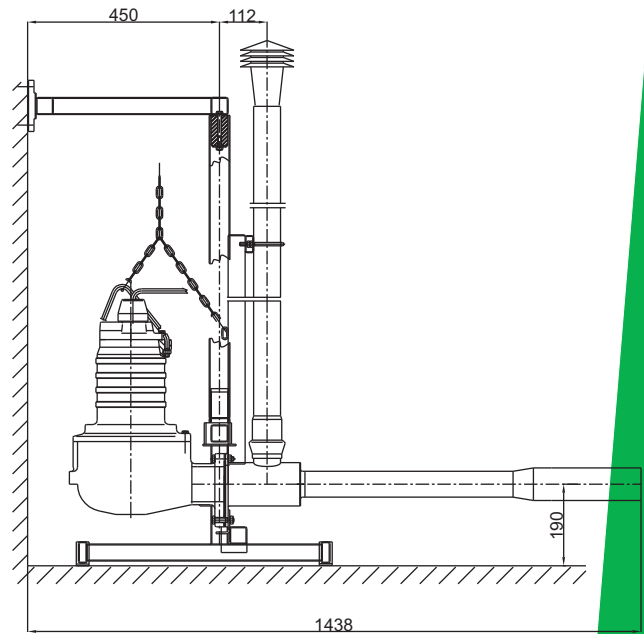

Jet pump S1-14Z; -24Z; -34Z; -44Z

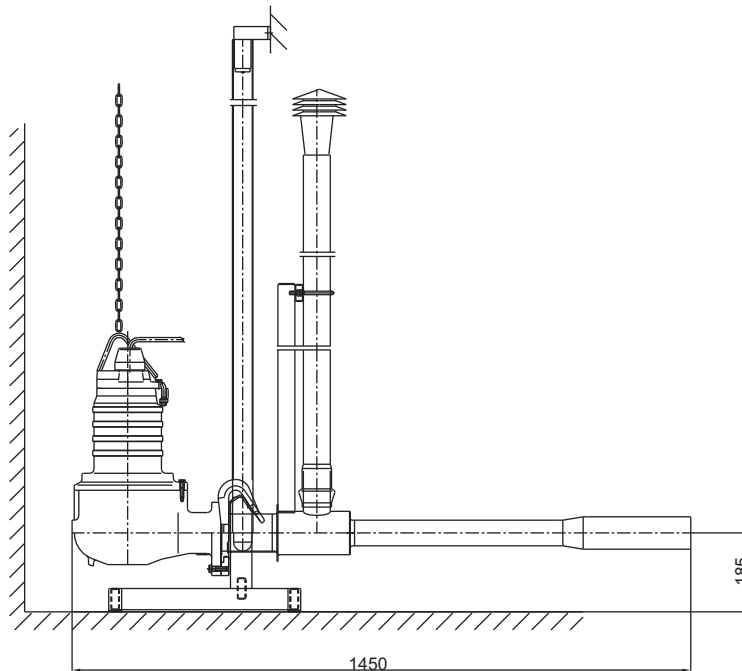
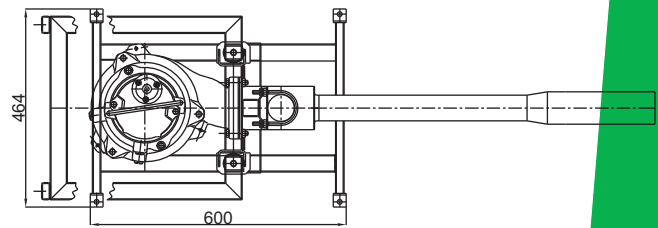
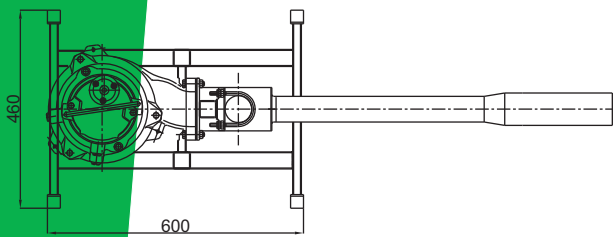

Jet pumps S1-14PZ; -24PZ; -34PZ; -44PZ

